

Kirby Morgan 37 Helmet P/N 500-050 / 500-051



| Location # | Part # | Description |
|------------|---------|--|
| 1 | 520-054 | Visor |
| 2 | 510-754 | Head Cushion Assembly |
| | 510-722 | Head Cushion Bag |
| 3 | 510-837 | Head Cushion Foam Spacer Assembly (Order P/N 525-745) |
| | 510-836 | Head Cushion Foam Spacer Bag |
| 4 | 510-683 | Chin Cushion Assembly |
| | 510-639 | Chin Cushion Bag |
| 5 | 505-024 | Side Block Assembly (B) |
| | 505-025 | Side Block Assembly (B), Brass |
| 6 | 520-033 | O-ring, Teflon® |
| 7 | 555-154 | Bent tube Assembly, No O-rings |
| 8 | 510-012 | O-ring |
| 9 | 555-155 | Bent Tube Assem w/O-rings |
| 10 | 560-125 | Weight, Top |
| | 560-116 | Weight, Top, Brass |
| 11 | 530-070 | Screw |
| 12 | 530-032 | Screw |
| 13 | 530-070 | Screw |
| 14 | 530-540 | Washer |
| 15 | 505-107 | Helmet Shell, 37 with Ring |
| 16 | 530-078 | Screw |
| 17 | 530-540 | Washer |
| 18 | 530-527 | Washer |
| 19 | 530-078 | Screw |
| 20 | 560-133 | Handle, 37 |
| | 560-136 | Handle, Brass, 37 |
| 21 | 560-192 | Plaque, 37 |
| 22 | 560-194 | Handle with Plaque, 37 |
| | 560-195 | Handle with Plaque, Brass 37 |
| 23 | 530-045 | Screw |
| 24 | 510-762 | Air Train Gasket |
| 25 | 530-050 | Screw |
| 26 | 530-535 | Washer |
| 27 | 530-415 | Washer, Lock |
| 28 | 530-317 | Nut |
| 29 | 545-016 | Air Train |
| 30 | 530-535 | Washer |
| 31 | 530-317 | Nut |
| 32 | 560-032 | Weight, Port Side |
| | 560-033 | Weight, Port Side, Brass |
| 33 | 530-062 | Screw |
| 34 | 530-052 | Screw |
| 35 | 530-035 | Screw |

| Location # | Part # | Description |
|------------|---------|---|
| 36 | 550-062 | Knob, Nose Block |
| | 550-252 | Knob, Nose Block, Brass |
| 37 | 555-180 | Packing Nut |
| | 555-190 | Packing Nut, Brass |
| 38 | 510-008 | O-ring |
| 39 | 550-116 | Nose Block Guide |
| | 550-249 | Nose Block Guide, Brass |
| 40 | 560-070 | Port Retainer, w/#39 |
| | 560-071 | Port Retainer, Brass, w/#39 Brass |
| 41 | 510-010 | O-ring |
| 42 | 520-004 | Face Port |
| 43 | 510-260 | O-ring, View Port |
| 44 | 530-015 | Screw |
| 45 | 505-110 | Sealed Pull Pin |
| 46 | 530-032 | Screw |
| 47 | 530-059 | Screw |
| 48 | 540-039 | Front Stand Off |
| 49 | 550-063 | Body, Water Dump |
| 50 | 510-561 | Valve, Water Dump, Black |
| 51 | 510-033 | O-ring |
| 52 | 520-042 | Tie Wrap |
| 53 | 530-019 | Screw |
| 54 | 510-007 | O-ring |
| 55 | 560-530 | Cover, Water Dump Adapter |
| 56 | 505-111 | Chin Strap Assembly Purchase 525-716 Kit |
| 57 | 510-786 | Starboard Whisker Wing |
| 58 | 510-760 | Quad Valve Exhaust Main Body |
| 59 | 520-042 | Tie Wrap |
| 60 | 520-200 | Whisker Exhaust Valve Insert |
| 61 | 510-776 | Exhaust Valve |
| 62 | 520-118 | Tri/Quad Valve Whisker Clamp |
| 63 | 530-008 | Brass Screw |
| 64 | 530-009 | Brass Nut |
| 65 | 510-787 | Port Whisker Wing |
| 66 | 505-730 | Quad Valve Exhaust Assembly |
| 67 | 530-045 | Screw |
| 68 | 550-061 | Spacer |
| 69 | 540-015 | Kidney Plate |
| 70 | 505-069 | SuperFlow® 350 Regulator Assembly Purchase 525-771 Kit |
| 71 | 530-546 | Washer for Swing Catch |
| 72 | 530-035 | Screw |
| 73 | 550-061 | Spacer |
| 74 | 540-086 | Swing Catch |

| Location # | Part # | Description |
|------------|---------|---|
| 75 | 520-167 | Teflon® Washer for Swing Catch |
| 76 | 535-825 | Spring, Swing Catch |
| 77 | 530-045 | Screw |
| 78 | 550-122 | Spring Spacer |
| 79 | 505-119 | Neck Ring Assembly (neoprene) Med. |
| 80 | 530-545 | Washer |
| 81 | 530-028 | Lock Nut |
| 82 | 560-111 | Locking Collar |
| 83 | 550-113 | Adjustment Nut, Neck Pad |
| 84 | 520-098 | Neck Pad |
| 85 | 530-064 | Screw |
| 86 | 550-045 | T-Washer |
| 87 | 530-027 | Hinge Bolt |
| 88 | 520-165 | Washer |
| 89 | 320-026 | Comm. Mount Nut |
| 90 | 515-029 | Microphone Assembly |
| 91 | 515-019 | Earphone, Left, 15.5" |
| 92 | 515-018 | Earphone, Right, 9" |
| 93 | 515-024 | Comm. Assembly w/MWP |
| 94 | 515-023 | Comm. Assembly w/Posts |
| 95 | 510-575 | Nose Block Pad |
| 96 | 545-015 | Nose Block Device <i>Includes location #95</i> |
| 97 | 520-020 | Valve Body |
| 98 | 510-550 | Valve, Oral Nasal |
| 99 | 510-747 | Oral Nasal Mask |
| 100 | 550-081 | Nut, Regulator Mount |
| 101 | 510-490 | O-ring |
| 102 | 540-054 | Earphone Retainer |
| 103 | 530-519 | Washer |
| 104 | 530-018 | Screw |
| 105 | 530-702 | Snap |
| 106 | 530-527 | Washer |
| 107 | 530-031 | Screw |

⚠ CAUTION

Use only Kirby Morgan original replacement parts. The use of other manufacturers' parts will interfere with the performance characteristics of your life support equipment and may jeopardize your safety. Additionally, any substitutions will void any warranties offered by KMDSI. When ordering spares, always insist on Kirby Morgan original parts.



Kirby Morgan Dive Systems, Inc.® 1430 Jason Way, Santa Maria, CA 93455
 Phone: 805/928-7772 Fax: 805/928-0342
www.KirbyMorgan.com e-mail: kmdsi@KirbyMorgan.com

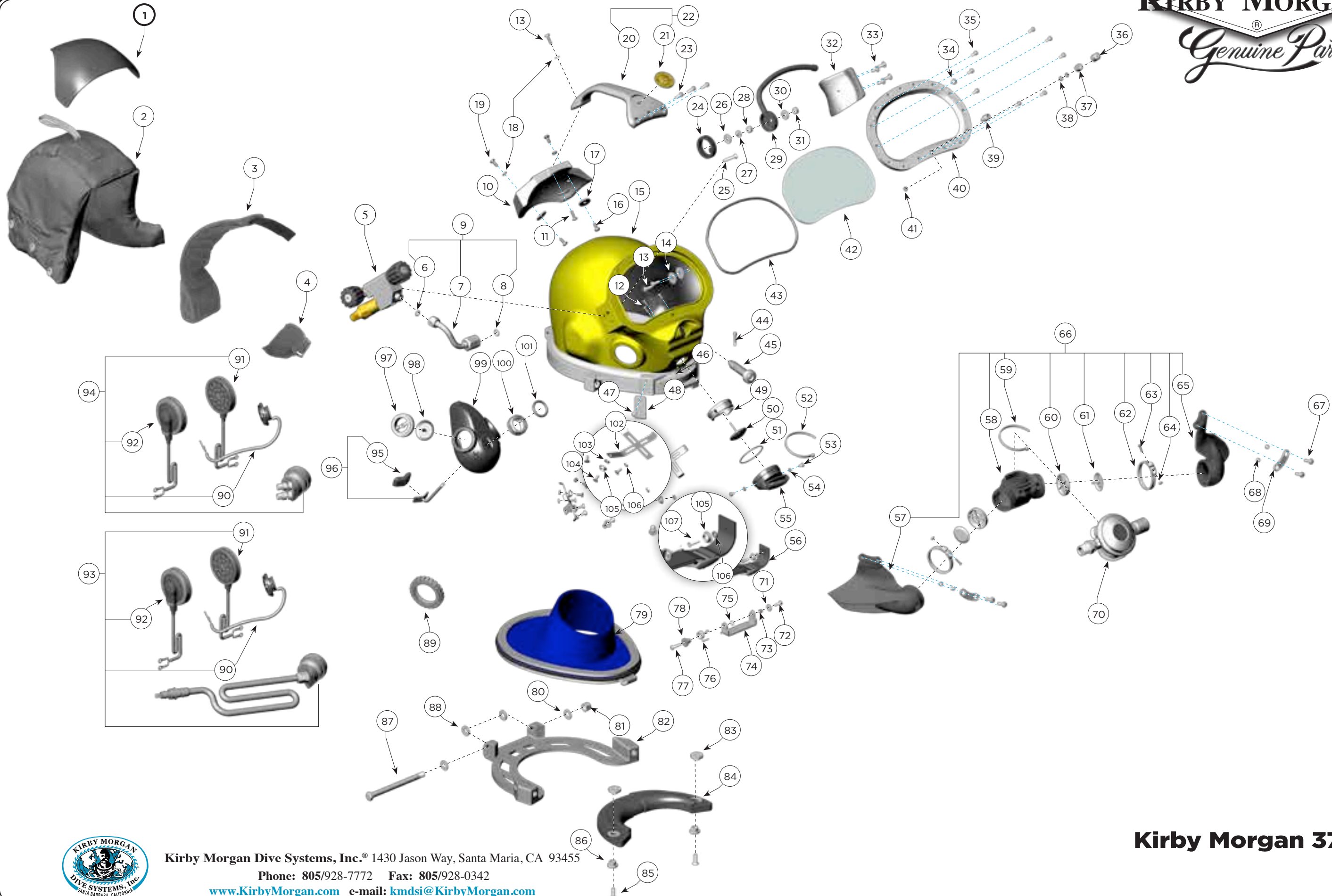

Kirby Morgan Dive Systems, Inc. 1430 Jason Way, Santa Maria, CA 93455
 Phone: 805/928-7772 Fax: 805/928-0342
www.KirbyMorgan.com e-mail: kmdsi@KirbyMorgan.com

Kirby Morgan 37 Helmet