



Kirby Morgan 37SS Helmet P/N 500-100 / 500-101

Location #	Part #	Description
1	510-575	Nose Block Pad
2	545-015	Nose Block Device <i>Includes location #1</i>
3	520-020	Valve Body
4	510-550	Valve, Oral Nasal
5	510-747	Oral Nasal Mask
6	530-058	Screw
7	330-405	Washer, Lock
8	540-579	Handle, Helmet, KM 37SS
9	530-059	Screw
10	510-795	Grip, Handle
11	430-075	Washer
12	530-052	Screw
13	505-765	Handle Assembly, KM 37SS
14	560-517	Helmet Shell, Stainless Steel
15	505-753	Airtrain Assembly, Stainless Helmet
16	550-571	Sleeve
17	530-083	Screw
18	550-574	Sleeve
19	530-535	Washer
20	530-415	Washer
21	530-317	Nut
22	530-059	Screw
23	550-566	Adapter
24	530-052	Screw
25	550-062	Knob, Nose Block
26	555-180	Packing Nut, Nose Block
27	510-008	O-ring
28	550-577	Nose Block Guide
29	505-738	Port Retainer Assembly
30	510-010	O-ring
31	520-004	Face Port
32	510-260	O-ring, View Port
33	550-081	Regulator Mount Nut
34	510-490	O-ring
35	550-097	Large Port Plug Body
36	510-029	O-ring
37	510-481	O-ring
38	550-043	Plug
39	320-026	Comm. Mount Nut
40	505-089	Large Port Plug Assembly <i>Includes location #s 35-39</i>
41	530-145	Nut
42	530-527	Washer

Location #	Part #	Description
43	510-403	Gasket, Pod
44	540-012	Retainer Ring
45	520-022	Exhaust Valve Insert
46	510-776	Exhaust Valve
47	510-019	O-ring
48	560-556	Regulator Mount Pod, 350
49	520-042	Tie Wrap
50	430-134	Washer
51	530-089	Screw
52	530-086	Screw
53	520-042	Tie Wrap
54	520-200	Valve Seat
55	510-776	Exhaust Valve
56	530-008	Brass Screw
57	520-118	Tri/Quad Valve Whisker Clamp
58	510-787	Port Whisker Wing
59	540-015	Kidney Plate
60	550-586	Spacer, Whisker
61	530-070	Screw
62	560-300	Zinc Whisker Anode
63	530-009	Brass Nut
64	505-069	Regulator Assembly, 1" Mount Tube Purchase 525-771
65	510-760	Main Body Quad Valve Exhaust
66	510-786	Starboard Whisker Wing
67	505-730	Quad Valve Exhaust Assembly 350 Regulator Pod Assembly
68	505-758	<i>Also includes location #s 33 and 34 (Order P/N 525-385)</i>
69	530-145	Lock Nut
70	530-086	Screw
71	530-032	Screw
72	530-035	Screw
73	530-546	Washer for Swing Catch
74	550-061	Spacer
75	540-086	Swing Catch
76	520-167	Teflon® Washer for Swing Catch
77	535-825	Spring, Swing Catch
78	550-122	Spring Spacer
79	530-045	Screw
80	505-748	Chin Strap Assembly, w/ Snaps, S.S.
81	530-028	Lock Nut
82	505-755	Locking Collar Assembly, S.S.
83	530-027	Hinge Bolt

Location #	Part #	Description
84	520-165	Washer
85	530-545	Washer
86	505-746	Neck Ring Assembly, Medium, S.S.
87	530-037	Screw
88	505-742	Earphone Retainer Assembly, S.S.
89	505-740	Snap Assembly, S.S.
90	505-110	Sealed Pull Pin Assembly
91	530-059	Screw
92	540-039	Front Stand Off
93	525-116	Front Stand Off Kit <i>(2 each of Loc. # 91 and 92)</i>
94	530-015	Screw
95	320-026	Comm. Mount Nut
96	515-018	Earphone, Right, 9"
97	515-019	Earphone, Left, 15.5"
98	515-029	Microphone Assembly
99	515-024	Comm. Assembly w/MWP
100	515-023	Comm. Assembly w/Posts
101	505-732	Side block Assembly
102	520-033	O-ring, Teflon®
103	555-154	Bent Tube Assembly, No O-rings
104	510-012	O-ring
105	555-155	Bent Tube Assembly w/O-rings
106	560-304	Zinc Sleeve Anode
107	520-038	Tie Wrap
108	510-683	Chin Cushion Assembly
	510-639	Chin Cushion Bag
109	510-837	Head Cushion Foam Spacer Assembly <i>(Order P/N 525-745)</i>
	510-836	Head Cushion Foam Spacer Bag
110	510-754	Head Cushion Assembly
	510-722	Head Cushion Bag

⚠ CAUTION

Use only Kirby Morgan original replacement parts. The use of other manufacturers' parts will interfere with the performance characteristics of your life support equipment and may jeopardize your safety. Additionally, any substitutions will void any warranties offered by KMDSI. When ordering spares, always insist on Kirby Morgan original parts.



Kirby Morgan Dive Systems, Inc.® 1430 Jason Way, Santa Maria, CA 93455

Phone: 805/928-7772 Fax: 805/928-0342

www.KirbyMorgan.com e-mail: kmdsi@KirbyMorgan.com

Kirby Morgan 37SS Helmet

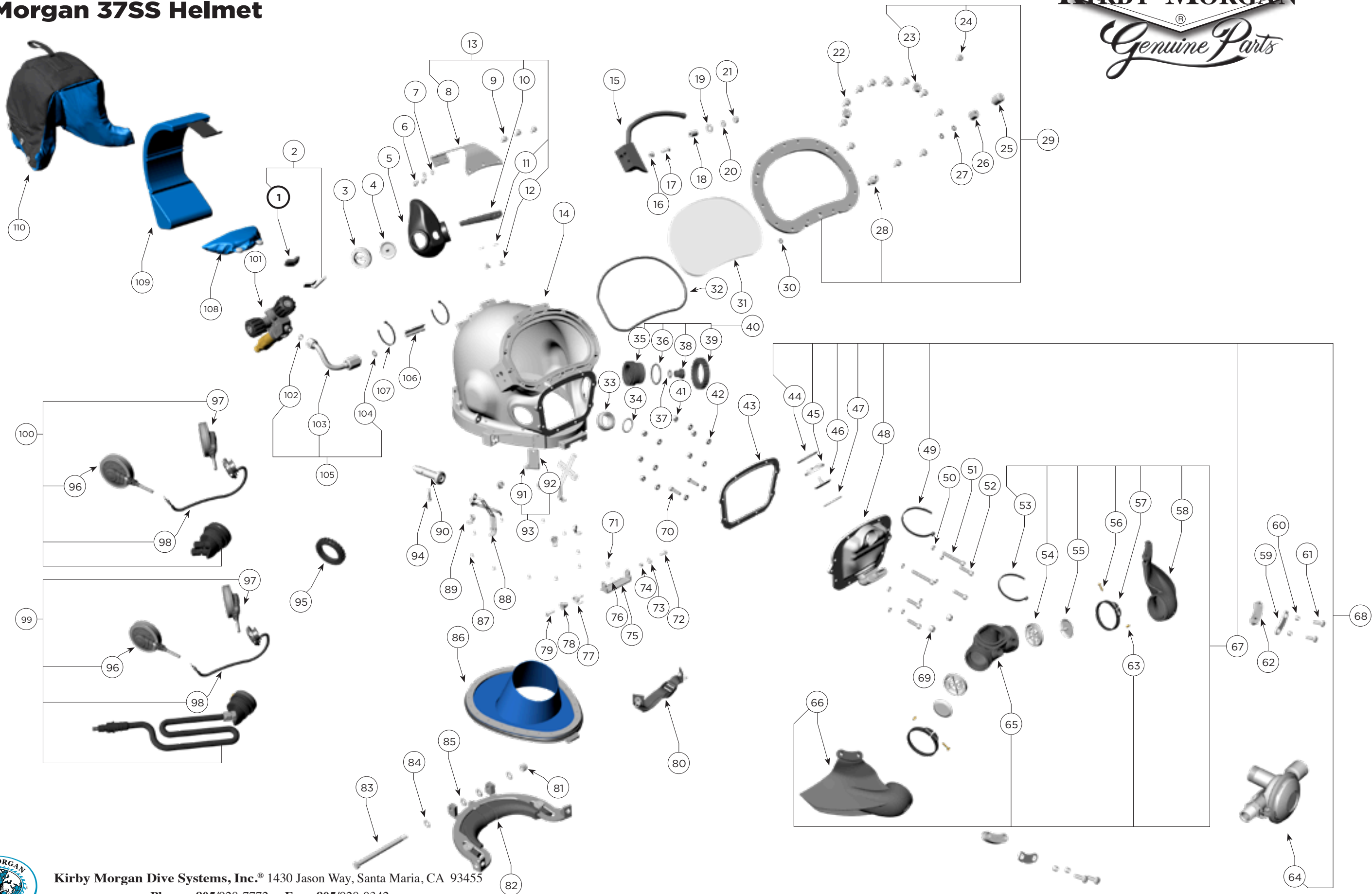

Kirby Morgan Dive Systems, Inc.® 1430 Jason Way, Santa Maria, CA 93455
 Phone: 805/928-7772 Fax: 805/928-0342
www.KirbyMorgan.com e-mail: kmdsi@KirbyMorgan.com